

Variolink Esthetic® DC

Eingliederung von Inlays (Glaskeramik, Composite)

Einprobe

Variolink Esthetic Try-In

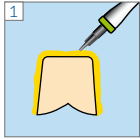

Auftragen der Try-In Paste

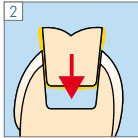

Einprobe der Restauration

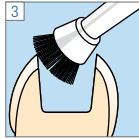

Reinigung nach der Einprobe

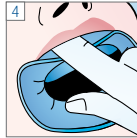

Trockenlegung

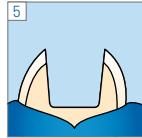

Restauration

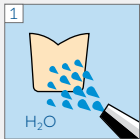

H₂O



LUFT!

Vorbehandlung von Keramik-restaurationen:

Gemäss Herstellerangaben
 Z.B. IPS Empress: 60 s ätzen
 IPS e.max CAD/Press: 20 s ätzen mit IPS Ceramic Ätzel (Flusssäure).
 Sicherheitshinweise beachten.

Vorbehandlung von Composite-Restaurationen:

Gemäss Herstellerangaben
 Z.B. SR Nexco, 2 bar, Al₂O₃, 100 µm
 oder mit Finierdiamanten aufrauen.

Monobond Plus

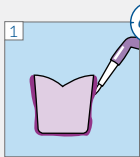

Präparation

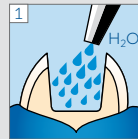

H₂O



LUFT!

Total Etch:

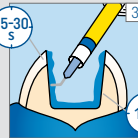

15-30 s

optional

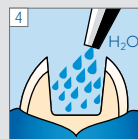

H₂O



LUFT!

Adhese Universal

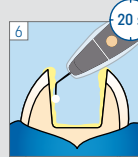

20 s

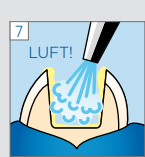

LUFT!

Pfützenbildung vermeiden

Bluephase G4

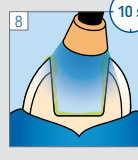

10 s

Befestigung

Variolink Esthetic DC

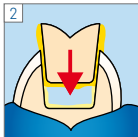
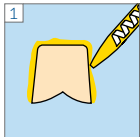

Bluephase G4

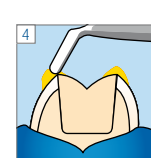
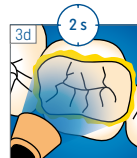
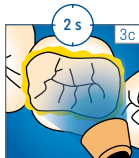
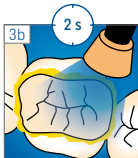
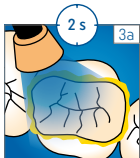

Restauration bis zum Ende der abschliessenden Polymerisation fixieren

Liquid Strip

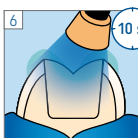
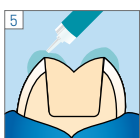
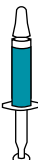

* pro Segment und mm Keramik

Polieren

Fluor Protector S

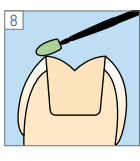

Hersteller
 Ivoclar Vivadent AG
 Bendorferstrasse 2
 9494 Schaan/Liechtenstein
 www.ivoclar.com

CE 0123



See Instructions

Erstellungsdatum:
 2022-08-23
 666356/DE/Rev. 1

ivoclar



mehr Informationen unter
www.cementation-navigation.com

Variolink Esthetic® DC

Eingliederung von Kronen und Brücken (Glaskeramik, Oxidkeramik, Composite)

Einprobe

Variolink Esthetic Try-In



Restauration

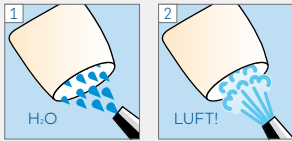

Vorbereitung von Glaskeramik-restorationen:
Gemäss Herstellerangaben
Z.B. IPS Empress: 60 s ätzen
IPS e.max CAD/Press: 20 s ätzen mit IPS Ceramic Ätzgel (Flusssäure).
Sicherheitshinweise beachten.

Vorbereitung von Oxidkeramik-restorationen:
Gemäss Herstellerangaben
Z.B. IPS e.max ZirCAD
max. 1 bar, Al₂O₃ 100 µm

Vorbereitung von Composite-Restaurationen:
Gemäss Herstellerangaben
Z.B. SR Nexco, 2 bar, Al₂O₃ 100 µm
oder mit Finierdiamanten aufrauen.

Monobond Plus

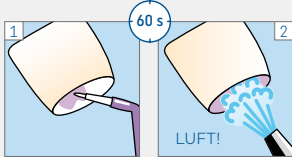

Präparation

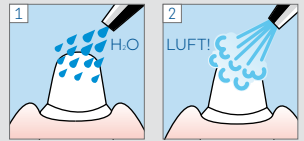

Total Etch:

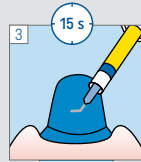

optional

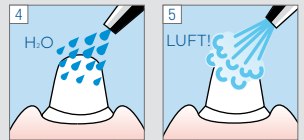

Adhese Universal

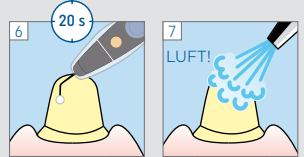

Pfützenbildung vermeiden

Bluephase G4

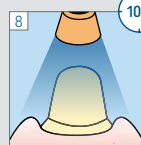

Befestigung

Variolink Esthetic DC

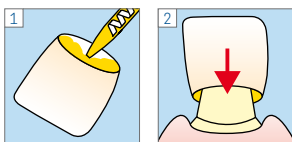

Bluephase G4

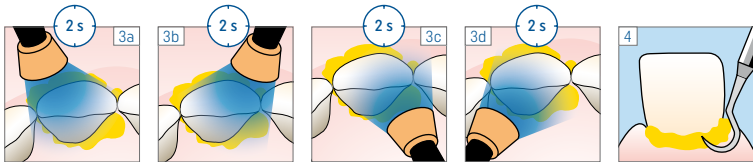

Restauration bis zum Ende der abschliessenden Polymerisation fixieren

Liquid Strip

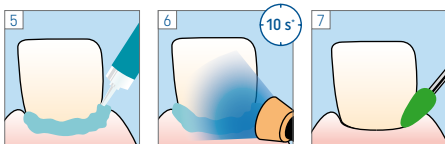
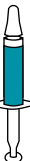

* pro Segment und mm Keramik

Polieren

Fluor Protector S

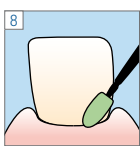

Hersteller
Ivoclar Vivadent AG
Bendererstrasse 2
9494 Schaan/Liechtenstein
www.ivoclar.com

CE 0123



See Instructions

Erstellungsdatum:
2022-08-23
666356/DE/Rev. 1

ivoclar



mehr Informationen unter
www.cementation-navigation.com