

# Variolink Esthetic® LC

Eingliederung von Veneers (Glaskeramik, Composite)

## Einprobe

Variolink Esthetic Try-In

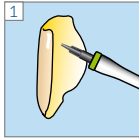

Auftragen der Try-In Paste

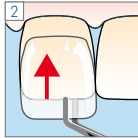

Einprobe der Restauration

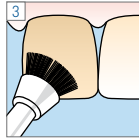

Reinigung nach der Einprobe

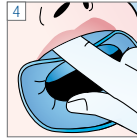

Trockenlegung

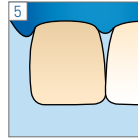

## Restauration

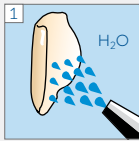

H<sub>2</sub>O

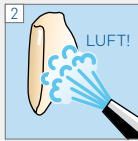

LUFT!

### Vorbehandlung von Keramik-restaurationen:

Gemäss Herstellerangaben  
 Z.B. IPS Empress: 60 s ätzen  
 IPS e.max CAD/Press: 20 s ätzen  
 mit IPS Ceramic Ätzel (Flusssäure).  
 Sicherheitshinweise beachten.

### Vorbehandlung von Composite-Restaurationen:

Gemäss Herstellerangaben  
 Z.B. SR Nexco, 2 bar, Al<sub>2</sub>O<sub>3</sub>, 100 µm  
 oder mit Finierdiamanten aufrauen.

Monobond Plus

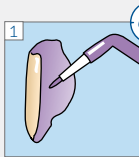

60 s

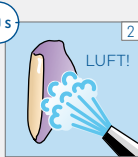

LUFT!

## Präparation

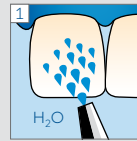

H<sub>2</sub>O



LUFT!

Total Etch:

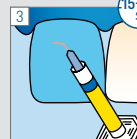

15-30 s

optional

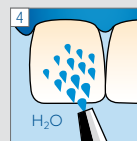

H<sub>2</sub>O

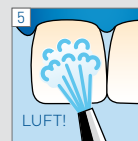

LUFT!

Adhese Universal

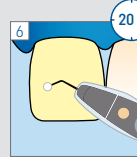

20 s

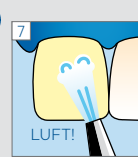

LUFT!

Pfützenbildung vermeiden

Bluephase G4



10 s

## Befestigung

Variolink Esthetic LC

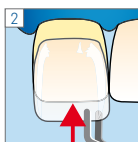
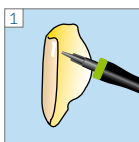

Bluephase G4



2 s

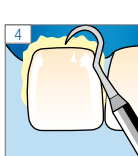

Restauration bis zum Ende der abschliessenden Polymerisation fixieren

Liquid Strip

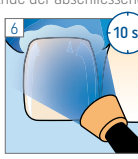
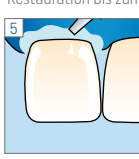
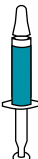

10 s

Polieren

Fluor Protector S

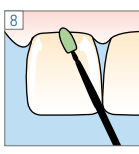

10 s



Hersteller  
 Ivoclar Vivadent AG  
 Beldererstrasse 2  
 9494 Schaan/Liechtenstein  
 www.ivoclar.com

CE 0123



See Instructions

Erstellungsdatum:  
 2022-08-23  
 666331/DE/Rev. 1



mehr Informationen unter  
[www.cementation-navigation.com](http://www.cementation-navigation.com)

ivoclar

# Variolink Esthetic® LC

Eingliederung von Inlays (Stärke < 2 mm) (Glaskeramik, Composite)

## Einprobe

Variolink Esthetic Try-In

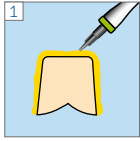

Auftragen der Try-In Paste

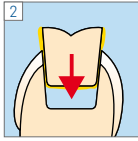

Einprobe der Restauration

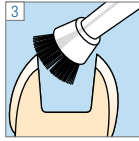

Reinigung nach der Einprobe

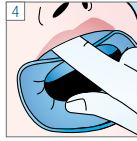

Trockenlegung

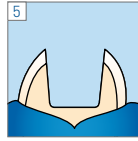

## Restauration

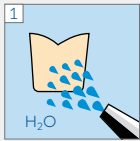

H<sub>2</sub>O



LUFT!

### Vorbehandlung von Keramik-restaurationen:

Gemäss Herstellerangaben  
 Z.B. IPS Empress: 60 s ätzen  
 IPS e.max CAD/Press: 20 s ätzen mit IPS Ceramic Ätzel (Flusssäure).  
 Sicherheitshinweise beachten.

### Vorbehandlung von Composite-Restaurationen:

Gemäss Herstellerangaben  
 Z.B. SR Nexco, 2 bar, Al<sub>2</sub>O<sub>3</sub>, 100 µm  
 oder mit Finierdiamanten aufrauen.

Monobond Plus

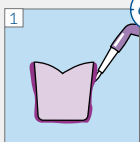

60 s



LUFT!

## Präparation

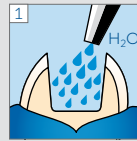

H<sub>2</sub>O



LUFT!

### Total Etch:

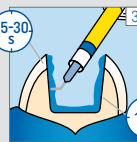

15-30 s

optional

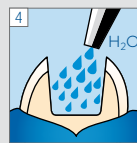

H<sub>2</sub>O



LUFT!

Adhese Universal

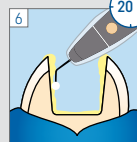

20 s



LUFT!

Pfützenbildung vermeiden

Bluephase G4

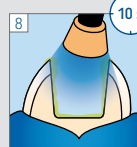

10 s

## Befestigung

Variolink Esthetic LC

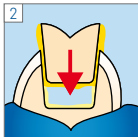
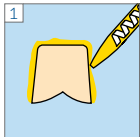

Bluephase G4



Restauration bis zum Ende der abschliessenden Polymerisation fixieren

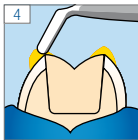

Liquid Strip

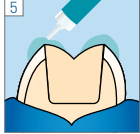

\* pro Segment und mm Keramik

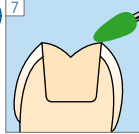

Polieren

Fluor Protector S

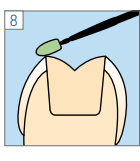

CE 0123



See Instructions

Hersteller  
 Ivoclar Vivadent AG  
 Beldererstrasse 2  
 9494 Schaan/Liechtenstein  
 www.ivoclar.com

Erstellungsdatum:  
 2022-08-23  
 666331/DE/Rev. 1



mehr Informationen unter  
[www.cementation-navigation.com](http://www.cementation-navigation.com)

ivoclar